

## **Tillers**

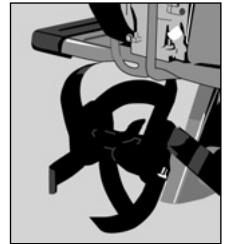

### **Overview**

1. New engine
  2. Modified V-belt pulley
  3. Modified clutch lever (VH 400)
  4. Modified clutch lever (VH 440)
  5. Modified sticker
-

### 1. New engine

In order to improve functionality, a new engine is used on models VH 400 and VH 440.

This engine fulfils the requirements with regard to noise reduction. The maximum engine speed has therefore been increased from 2700 rpm to 3000 rpm.

The B&S engine 1 has been newly introduced as a spare part by VIKING. Individual engine parts must still be ordered from B&S.

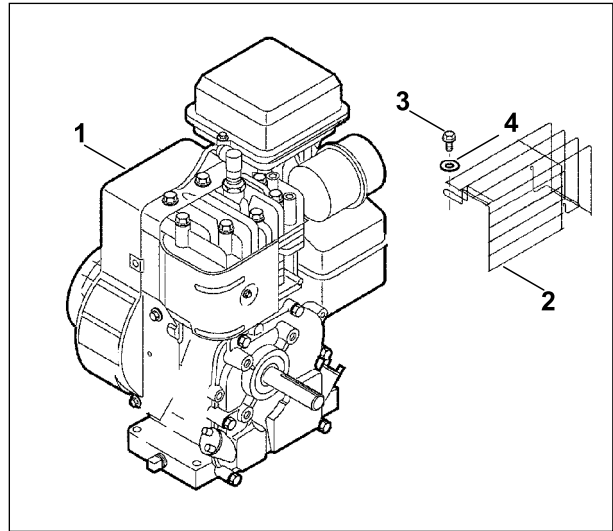

Previous version

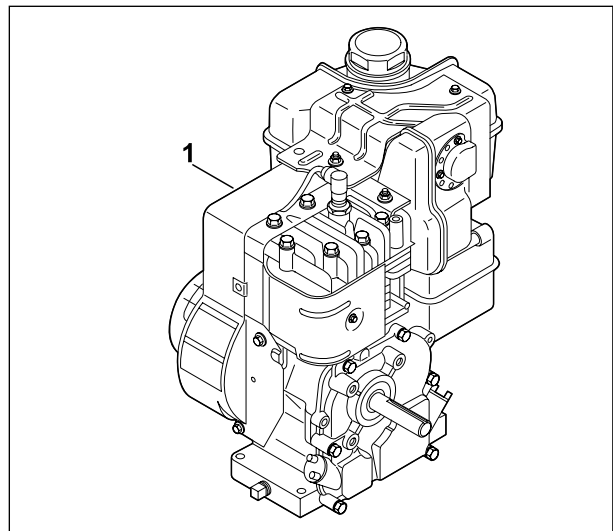

New version

### Application of changes

Model	from serial number
VH 400	9 75 094 876
VH 440	9 75 095 260

### Summary

Item	Designation	Previous version	New version	Note
1	B&S Power Built engine (093312)	*)	6226 011 1803	(2), (D)
2	Exhaust guard	6226 140 6000	-	(2), (A)
3	Self-tapping screw	9039 488 0975	-	(2), (A)
4	Washer	9291 020 0140	-	(2), (A)

Note

- (1) The new version of the component is **exchangeable** with the previous version.
- (2) The new version of the component is **not exchangeable** with the previous version.
- (3) The previous version of the component **cannot be used** for new appliances. However, the new version of the component **can be used** for units of an older design.
- \*) The previous engine can be procured from Briggs & Stratton.

- (A) The previous version of the component is **still** available as a spare part.
- (B) The previous version of the component will **no longer** be available as a spare part **once stocks have been exhausted**.
- (C) The previous version of the component is **no longer** available as a spare part.
- (D) **New component**

## 2. Modified V-belt pulley

Due to the modified engine speed, the diameter of the pulley has been modified and the V-belt adapted.

The speed of the work tools (hoes, wheels) thus remains unchanged.

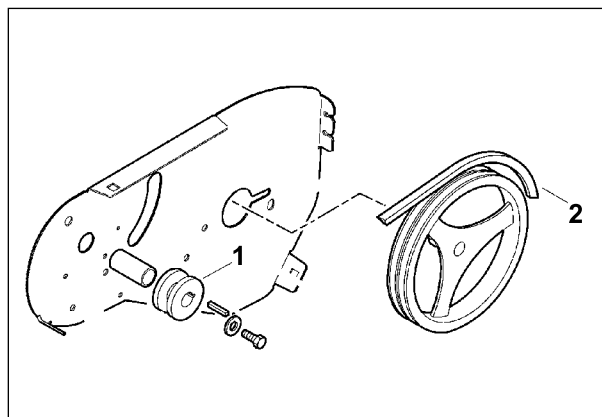

VH 400

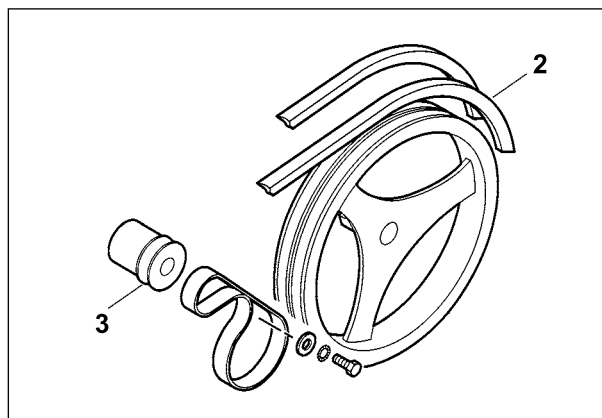

VH 440

### Application of changes

Model	from serial number
VH 400	9 75 094 876
VH 440	9 75 095 260

### Summary

Item	Designation	Previous version	New version	Note
1	V-belt pulley	6226 711 1202	6226 711 1201	(2), (A), (4)
2	V-belt	6226 711 5021	6226 711 5020	(2), (A)
3	Belt pulley	6226 711 6001	6226 711 6000	(2), (A), (5)

#### Note

- (1) The new version of the component is **exchangeable** with the previous version.
- (2) The new version of the component is **not exchangeable** with the previous version.
- (3) The previous version of the component **cannot be used** for new appliances. However, the new version of the component **can be used** for units of an older design.
- (4) Only applies to model VH 400
- (5) Only applies to model VH 440

- (A) The previous version of the component is **still** available as a spare part.
- (B) The previous version of the component will **no longer** be available as a spare part **once stocks have been exhausted**.
- (C) The previous version of the component is **no longer** available as a spare part.
- (D) **New component**



### 3. Modified clutch lever (VH 400)

In order to improve functionality, a modified clutch lever **2** is used on model VH 400. Due to the modified clutch lever **2**, console **1** and clutch cable **3** have also been modified.

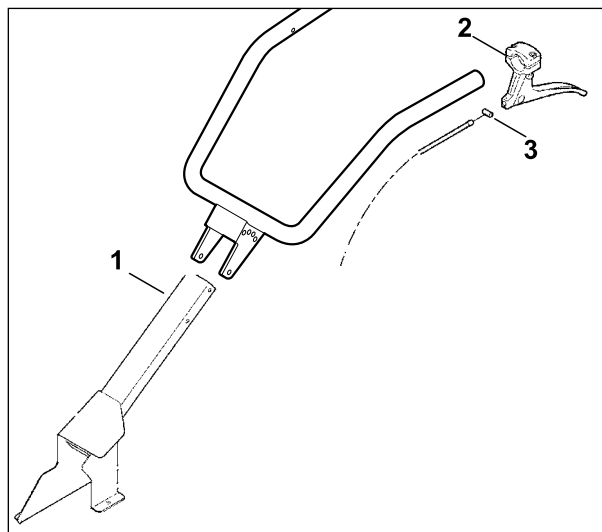

Previous version

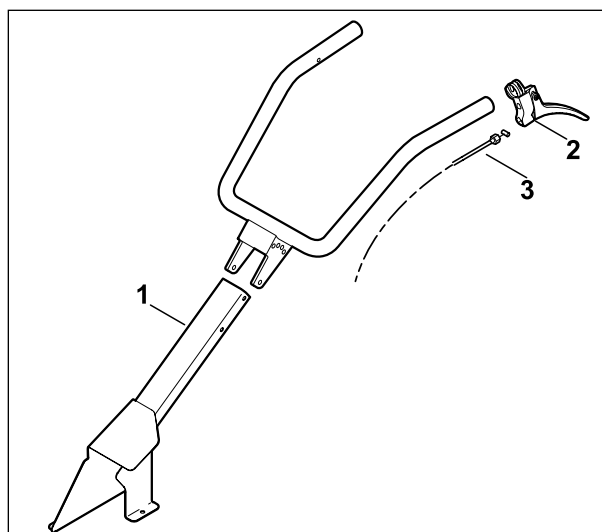

New version

#### Application of changes

Model	from serial number
VH 400	9 75 094 876

#### Summary

Item	Designation	Previous version	New version	Note
1	Console	6226 740 0201	6226 740 0202	(2), (A)
2	Clutch lever	6226 160 5700	6226 160 5701	(2), (A)
3	Clutch cable	6226 710 9901	6226 710 9902	(2), (A)

Note

- (1) The new version of the component is **exchangeable** with the previous version.
- (2) The new version of the component is **not exchangeable** with the previous version.
- (3) The previous version of the component **cannot be used** for new appliances. However, the new version of the component **can be used** for units of an older design.

- (A) The previous version of the component is **still** available as a spare part.
- (B) The previous version of the component will **no longer** be available as a spare part **once stocks have been exhausted**.
- (C) The previous version of the component is **no longer** available as a spare part.
- (D) **New component**

#### 4. Modified clutch lever (VH 440)

In order to improve functionality, a modified clutch lever **2** is used on model VH 440. Due to the modified clutch lever **2**, console **1**, clutch cable **3** and clutch cable **4** have also been modified.

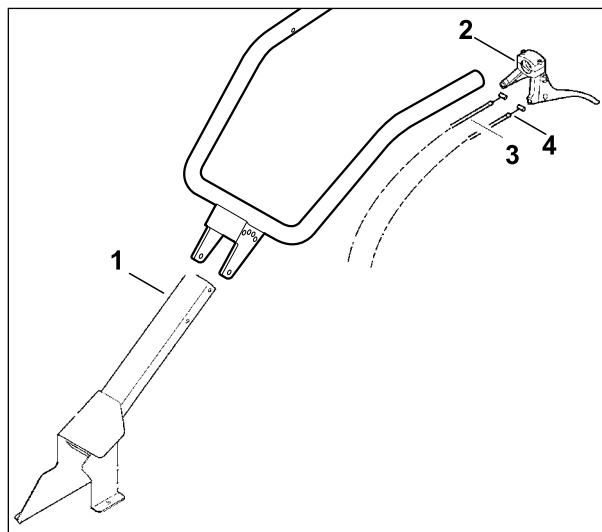

Previous version

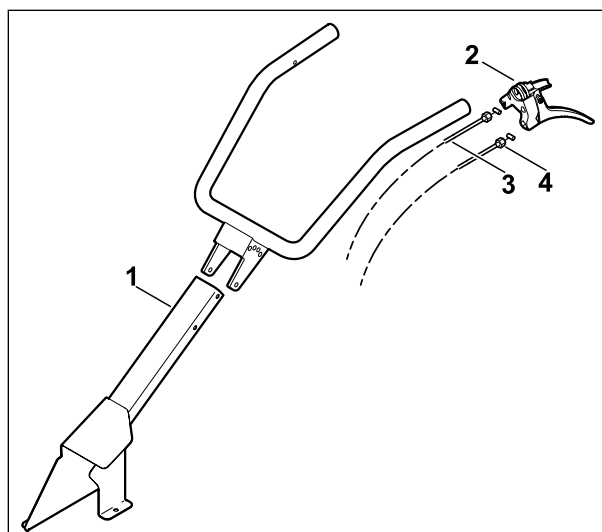

New version

#### Application of changes

Model	from serial number
VH 440	9 75 095 260

#### Summary

Item	Designation	Previous version	New version	Note
1	Console	6226 740 0201	6226 740 0202	(2), (A)
2	Clutch lever	6227 160 5700	6227 160 5701	(2), (A)
3	Clutch cable	6226 710 9901	6226 710 9902	(2), (A)
4	Clutch cable	6227 710 9906	6227 710 9907	(2), (A)

#### Note

- (1) The new version of the component is **exchangeable** with the previous version.
- (2) The new version of the component is **not exchangeable** with the previous version.
- (3) The previous version of the component **cannot be used** for new appliances. However, the new version of the component **can be used** for units of an older design.

- (A) The previous version of the component is **still** available as a spare part.
- (B) The previous version of the component will **no longer** be available as a spare part **once stocks have been exhausted**.
- (C) The previous version of the component is **no longer** available as a spare part.
- (D) **New component**



### 5. Modified sticker

Due to model improvement, stickers **1, 2 and 3** have been replaced by sticker **4**. Sticker **5** has also been introduced as a spare part.

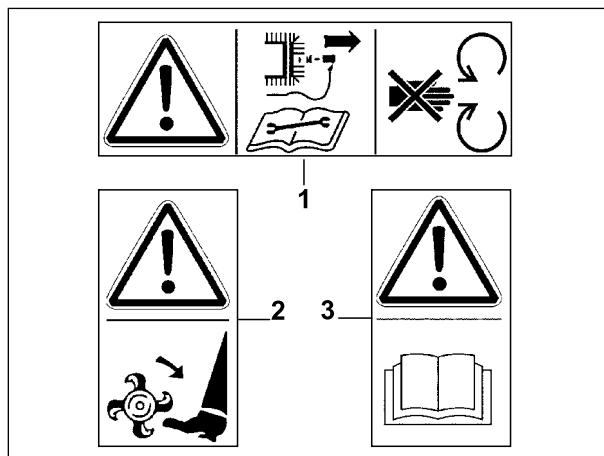

Previous version

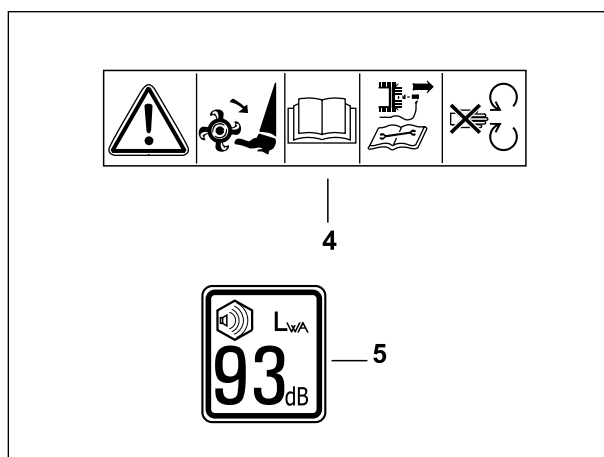

New version

#### Application of changes

Model	from serial number
VH 400	9 75 094 876
VH 440	9 75 095 260

#### Summary

Item	Designation	Previous version	New version	Note
1	Sticker	6226 967 4420	-	
2	Sticker	6226 967 4430	-	
3	Sticker	6226 967 4440	-	
4	Sticker	-	6226 967 4460	(D)
5	Sticker	-	6226 967 4450	(D)

Note

- (1) The new version of the component is **exchangeable** with the previous version.
- (2) The new version of the component is **not exchangeable** with the previous version.
- (3) The previous version of the component **cannot be used** for new appliances. However, the new version of the component **can be used** for units of an older design.

- (A) The previous version of the component is **still** available as a spare part.
- (B) The previous version of the component will **no longer** be available as a spare part **once stocks have been exhausted**.
- (C) The previous version of the component is **no longer** available as a spare part.
- (D) **New component**