



Satisfy Professional's Needs

Rotary Hammer  
HR2453 / HR2454 24mm (15/16")



SDS-Plus Shank

# High Durability

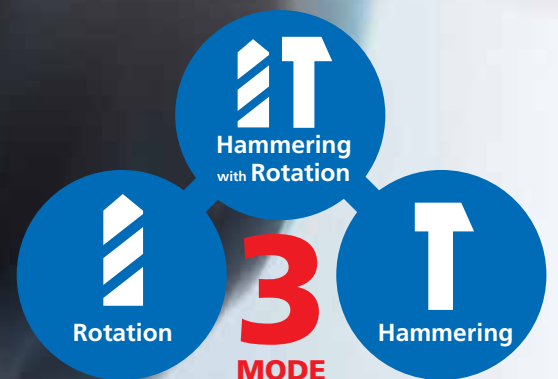
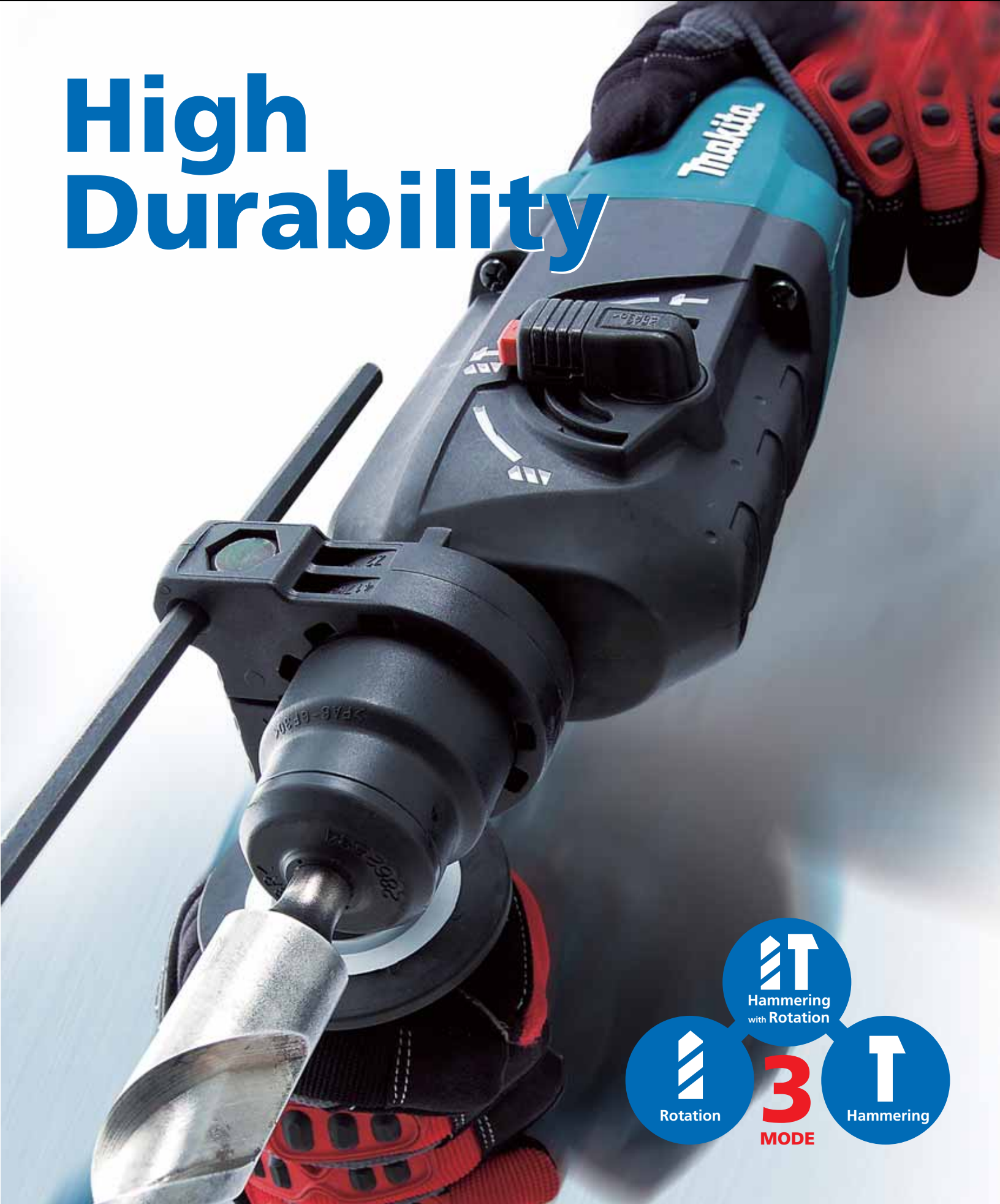

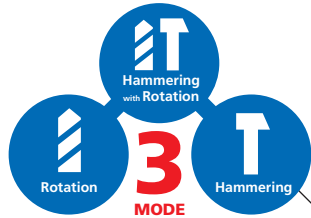

High Durable Structure

Torque Limiter

Variable speed control switch & Reverse switch (Reverse switch: HR2453 only)

Ergonomically designed rubberized grip

Anti slip rubberized side grip

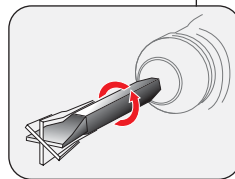

Chisel can rotate full 360 degrees with 40 different locking positions. (without using chisel adapter)

Option

<b>Drill chuck assembly</b> (Chuck adapter assembly and Drill chuck)	
Part No.	
122574-2	

<b>Dust extractor attachment</b>	
Part No.	
193472-7	

<b>Dust cup</b> (Protects operator from dust and debris)	

<b>Oil supply &amp; Grease vessel</b>	
	Part No.
Grease 30g	181490-7
Grease 100g (for bit)	181573-3

<b>Chuck adapter assembly</b> With screw M6 x 22	
Part No.	
122573-4	

<b>Hose</b>	
Inner dia.: 28mm, Length: 1.5m	
Part No.	
192278-0	

bit dia (mm)	Part No.
6-14.5	421342-3
12-16	421664-1

<b>Hammer service kit</b>	
Part No.	
193606-2	

Rotary Hammer **HR2453 / HR2454 24mm (15/16")**

419

- Double Insulation
- Variable Speed
- Reversing (HR2453 only)
- Torque Limiter
- Dust Collecting
- SDS-Plus Shank
- Carrying Case



<b>Continuous rating Input</b>	780W
<b>Capacity Concrete:</b>	24mm (15/16")
<b>Steel:</b>	13mm (1/2")
<b>Wood:</b>	32mm (1-1/4")
<b>Blows per minute:</b>	0 - 4,500 bpm
<b>No load speed</b>	0 - 1,100 rpm
<b>Dimensions (L x W x H)</b>	365 x 72 x 204mm (14-3/8" x 2-13/16" x 8")
<b>Net weight</b>	2.6kg (5.7lbs)
<b>Power supply cord</b>	4.0m (13.1ft)

**Standard equipment :**  
Depth Gauge, Side Grip (Tool does not come with bit)

Items of standard equipment and specifications may differ from country to country.

**Makita Corporation**

3-11-8 Sumiyoshi-cho, Anjo, Aichi, 446-8502 Japan